

Socket Allen Screw

Head Style: Cap Head

Drive Type: Internal Hex

Thread Type: Metric - Coarse

Material: Stainless Steel

Class Grade: A4-70 G316

Corrosion Protection Level: Ultimate

Standard: DIN 912 / A4

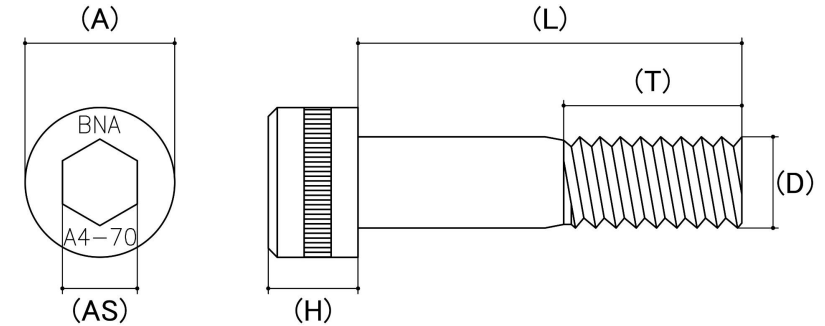

*CAD drawings shown for graphic representation only.**

Size	Thread Pitch (mm)	Thread Type	Product Diameter (D) (mm)		Head Diameter (A) (mm)		Head Height (H) (mm)		Driver Bit Size (AS) (mm)	sku (qfind)
			Min	Max	Min	Max	Min	Max	Nom	
M1.6	0.35	Coarse	1.49	1.58	2.86	3.00	1.46	1.70	1	31S1.6M
M2	0.40	Coarse	1.88	1.98	3.62	3.80	1.86	2.00	1	31S2M
M2.5	0.45	Coarse	2.38	2.48	4.32	4.50	2.36	2.50	2	31S25M
M3	0.50	Coarse	2.87	2.98	5.32	5.50	2.86	3.00	2	31S3M
M4	0.70	Coarse	3.83	3.97	6.78	7.00	3.82	4.00	3	31S4MFT
M5	0.80	Coarse	4.82	5.00	8.28	8.50	4.82	5.00	4	31S5MFT
M6	1.00	Coarse	5.82	6.00	9.78	10.00	5.70	6.00	5	31S6M
M8	1.25	Coarse	7.78	8.00	12.73	13.00	7.64	8.00	6	31S8M
M10	1.50	Coarse	9.78	10.00	15.73	16.00	9.64	10.00	8	31S10M
M12	1.75	Coarse	11.73	12.00	17.73	18.00	11.57	12.00	10	31S12M
M14	2.00	Coarse	13.73	14.00	20.67	21.00	13.57	14.00	12	31S14M
M16	2.00	Coarse	15.73	16.00	23.73	24.00	15.57	16.00	14	31S16M
M20	2.50	Coarse	19.67	20.00	29.53	30.00	19.73	20.00	17	31S20M

Disclaimer:

Dimensional data and technical information was obtained from publically available sources and not acquired through standard agencies. It has been completed and compiled for reference purposes only; where discrepancies are found they are subject to change without notice. Bolt & Nut Australia makes no warranties or representations regarding the accuracy and validity of the compiled information and data. Contact the relevant standard authorities for accurate and detailed information.

* CAD drawings may not reflect diameter, thread length or overall length.